

# OVERFLOW VALVES

Directly controlled, spring-loaded overflow valve to maintain a set operating pressure or a set maximum pressure. For lubricating and hydraulic oils and many other self-lubricating, non-corrosive fluids.

MODEL	PRESSURE RATING FOR TYPE (Order No.)	CONNECTION THREAD/ FLANGE	FLOW RATE(I) l/h	VISCOSITY RANGE(I) cSt	DIMENSIONS			
					A	B	C	D
2		G 1/4"	15 - 120	2,8 - 480	44	36	34	26
3		G 3/8"	24 - 160	2,8 - 480	55	51	37	36
5		G 1/2"	90 - 600	2,8 - 480	55	51	37	36
6		G 3/4"	300 - 2.000	2,8 - 480	63	50	60	73
7	0 = 0,5 - 1,5 bar 1 = 1 - 4 bar 2 = 2 - 9 bar 3 = 6 - 26 bar 4 = 15 - 40 bar	G 1"	300 - 2.000	2,8 - 480	80	48	58	86
8		G 1 1/4"	1.500 - 10.000	2,8 - 480	80	71	60	56
9		DN 15	90 - 600	2,8 - 480	92	55	95	92
10		DN 20	300 - 2.000	2,8 - 480	118	63	106	118
11		DN 25	900 - 6.000	2,8 - 480	134	80	115	134
12		DN 32	1.500 - 10.000	2,8 - 480	138	80	140	138
13		DN50	80000-200000	2,8-480	205	140	165	205

X- Closed or Pressure Gauge  
T- Tank (Overflow)  
P- Pressure

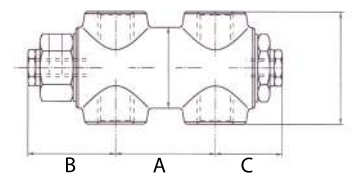
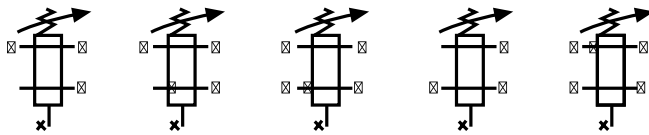

- A) 50° E=380 cSt  
380x10<sup>-6</sup> m<sup>2</sup>s<sup>-1</sup>
- B) 20° E=152 cSt  
152x10<sup>-6</sup> m<sup>2</sup>s<sup>-1</sup>
- C) 5° E=38 cSt  
38x10<sup>-6</sup> m<sup>2</sup>s<sup>-1</sup>
- D) 1,4° E=5cSt  
5x10<sup>-6</sup> m<sup>2</sup>s<sup>-1</sup>

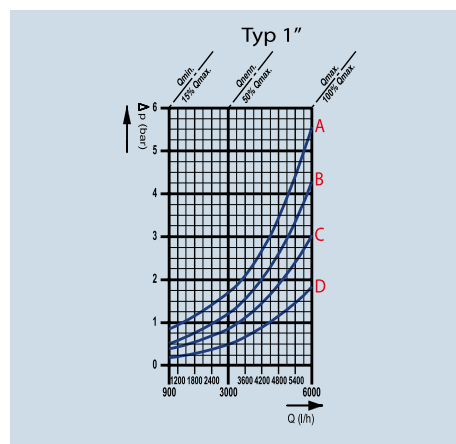
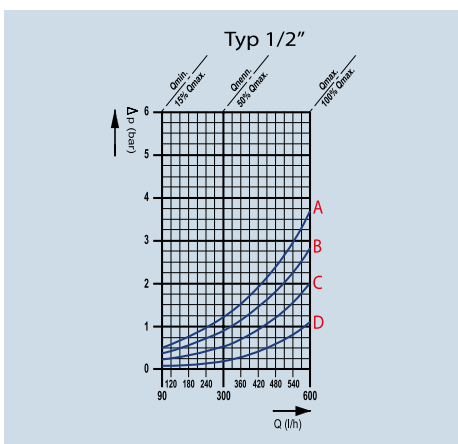
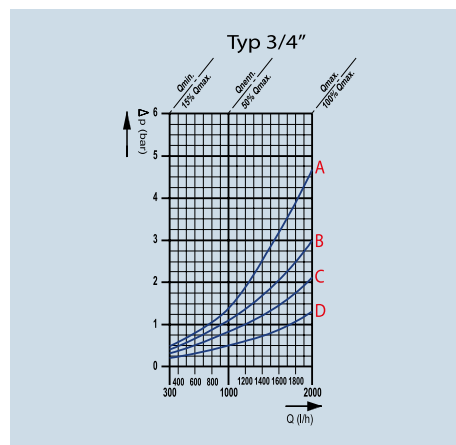
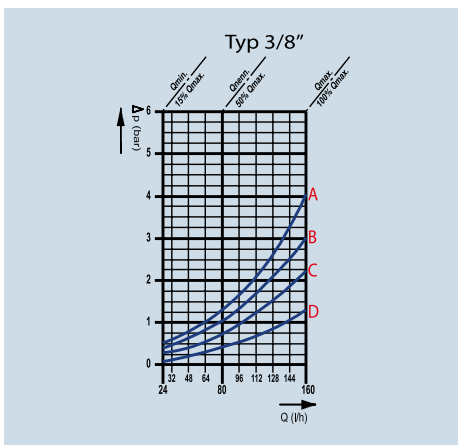

C/Invierno, 4-6 28500  
Arganda del Rey, Madrid (Spain)  
Telf.: (+34) 918 719 294  
info@inprord.com  
www.inprord.com



63457 Hanau - Voltastr, 10  
Deutschland (Germany)  
Telf.: (+49) 06181/9587-0  
info@simka.de  
www.simka.de